

PROFESSIONAL DRYERS

DPR 8
DPR 10



ROBUSTNESS

- Robust door in aluminium,
- Drawer as fluff filter : not in the door,
- Industrial fan and powerful airflow,
- Sturdy construction of the structure and panels,
- Same inverter as industrial dryers.



FEATURES

- **Two controls :**
EASY TOUCH 2 with 4,3" touch screen, user friendly and fully programmable,
EM electronic control: selection of time and temperature.
- Reduced drying time (less than 45 mn) : 6,75 kw heating, option 4,5 kw,
- Configurable heating,
- USB connexion.



VERSATILITY

- OPL <> COIN: standard model easily transformable.
- SINGLE <> STACKED.
- Reversible control panel.



EFFICIENCY

- improved air flow system.
- Large diameter of door, \varnothing 588 mm.
- Big fluff filter - better air efficiency
- CARE DRY humidity sensor (with ET2 control)
- Efficient driven design and construction



OTHERS

- Grey skinplate outercasing,
- Galvanized drum,
- Axial airflow,
- Electric heating,
- Easy access to components for easy maintenance,
- 230V single phased



OPTIONS

- Reversing door opening.
- AISI 304 stainless steel panels.
- Plinth for ergonomic height of loading.
- CARE DRY moisture control (with ET2 models only).
- Danube Online communication kit.
- self-service kits: coin or token meter + coin/token box, central pay.

TECHNICAL DATA	UNIT.	DPR 8		DPR 10	
DRUM					
Capacity 1:18 / 1:20	Kg	8,9 / 8		11,1 / 10	
Volume (litres)	l	160		200	
Diameter	mm	590		590	
Depth	mm	585		690	
Hourly output	kg/h	9,8		11,2	
Evaporation capacity	l/h	4,65		6,35	
DOOR					
Loading height (door center)	mm	554		554	
Loading height (door bottom)	mm	250		250	
Diameter	mm	588		588	
GENERAL DATA					
ET2 TOUCH CONTROL	-	Touch screen 4,3"		Touch screen 4,3"	
USB Connection	-	Yes		Yes	
Construction	-	Skinplate panels		skinplate panels	
Plinth	-	OPT		OPT	
Self-service version	-	Yes		Yes	
Niveau sonore	db	62		62	
POWER					
Motor	kW	0,37		0,37	
Electric heating	kW	4,5	6,75	4,5	6,75
Tension 230V I + N + T	Nº x mm2 / A	3 x 10 / 40A		3 x 10 / 40A	
Tension 230V - III + T	Nº x mm2 / A	4 x 4 / 25A		4 x 4 / 25A	
Tension 400V - III + N + T	Nº x mm2 / A	5 x 2,5 / 16A		5 x 2,5 / 16A	
CONNECTIONS					
Ø Exhaust	mm	100		100	
Airflow	m3/h	300		300	
DIMENSIONS / DIMENSIONS WITH PACKING					
Length	mm	680 / 710		680 / 710	
Depth	mm	722 / 832		775 / 832	
Height	mm	1.056/ 1.141		1.056 / 1.141	
Net weight / gross weight	kg	89 / 100,5		92,6 / 104,1	

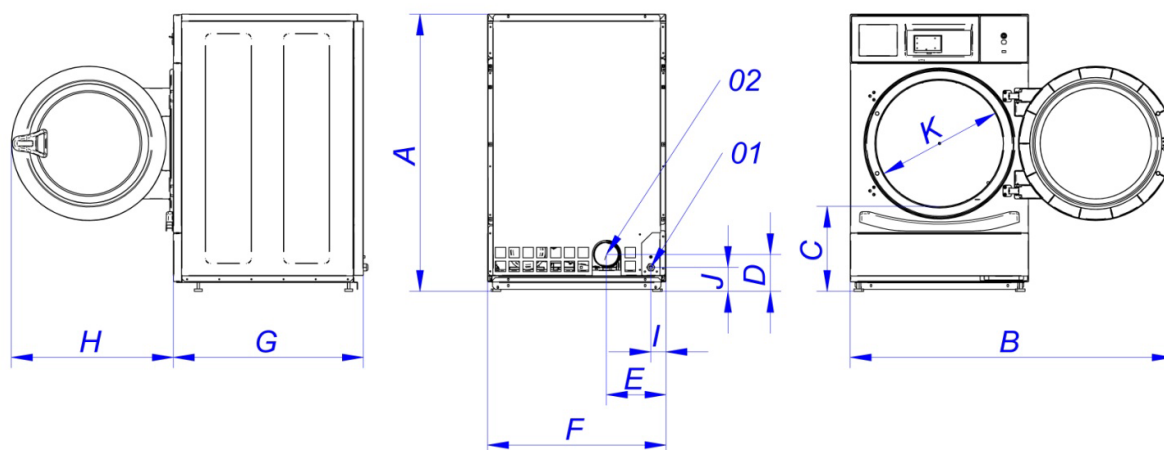

01. Electrical connection
02. Exhaust outlet ø 100

	A	B	C	D	E	F	G	H	I	J	K
DPR-8	1.056	1.227	320	140	226	680	722	615	57	91	480
DPR-10	1.056	1.227	320	140	226	680	775	615	57	91	480